

Cambridge Grove

Hove



About the property

This lovely, three-bedroom home is tucked away in a charming and colourful cobbled mews located in central Hove. South facing, the property is warm and bright with lovely decor throughout. Cambridge Grove is a moments walk from the seafront and Hove Station, ideal for anyone commuting to London.

Cambridge Grove Hove

£550,000



3

BEDROOM

1

RECEPTION

1

BATHROOM







SCAN HERE TO VIEW ALL AVAILABLE PROPERTIES

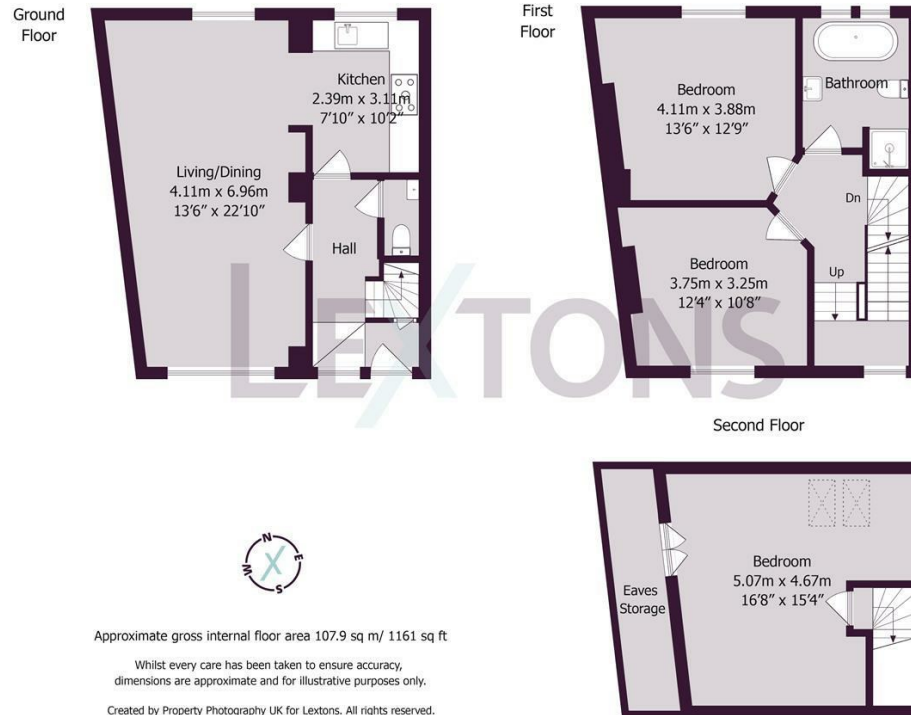

Energy Efficiency Rating		
	Current	Potential
<i>Very energy efficient - lower running costs</i>		
(92 plus) A		
(81-91) B		
(69-80) C		
(55-68) D		
(39-54) E		
(21-38) F		
(1-20) G		
<i>Not energy efficient - higher running costs</i>		
England & Wales	EU Directive 2002/91/EC	